

ASSEMBLY

1. Slide **A** on **B** aligning slots.
2. Slide **C** through rear slot in **A**.
3. Slide **D** through front slot in **A**.
4. Push **E** (x2) through holes in **D** & **B** and hand-tighten in **C**.

PARTS

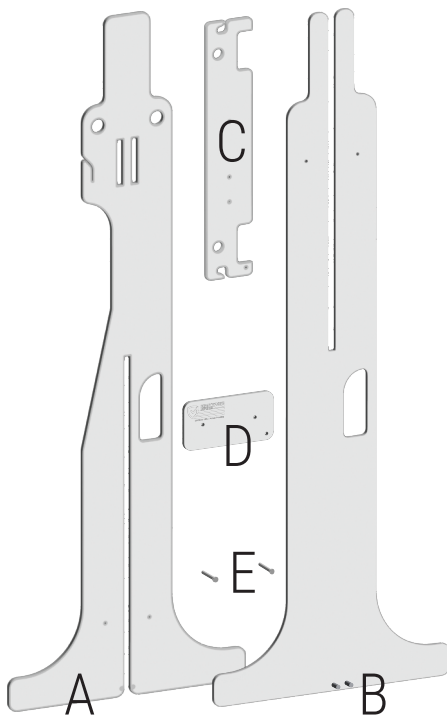

STEP 1

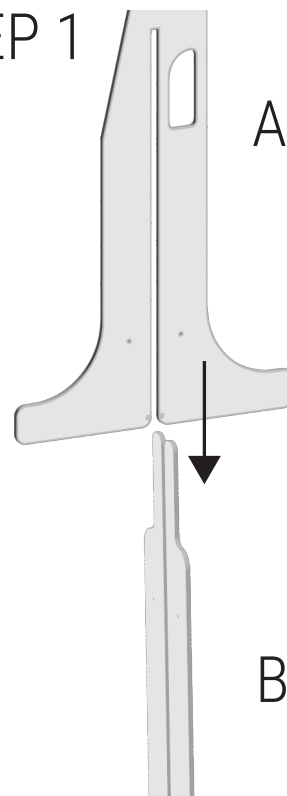

STEP 2

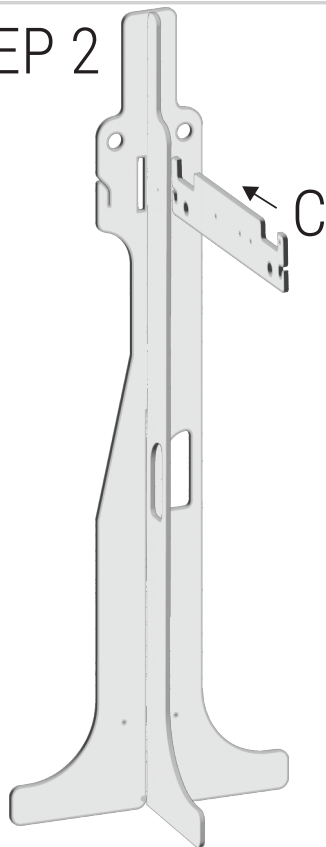

STEP 3

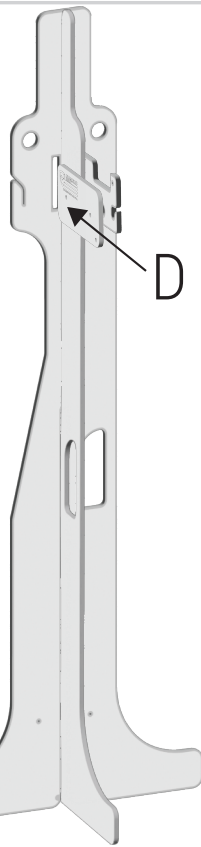

STEP 4

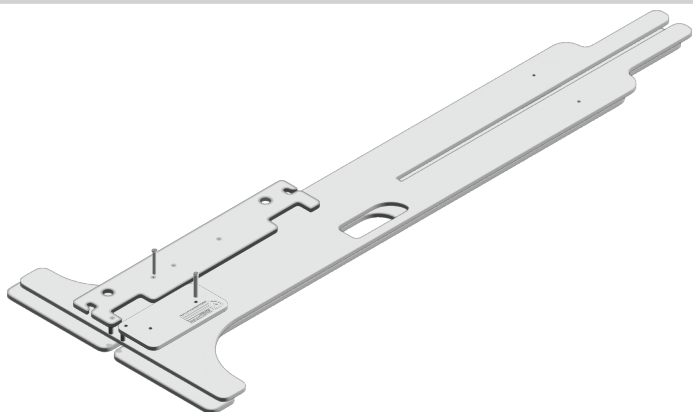
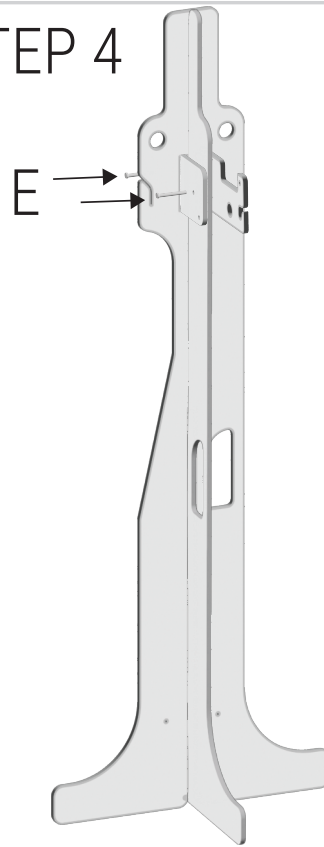

STORAGE/TRANSPORT

1. Place **A** on the ground.
2. Place **B** on **A** aligning pins in holes.
3. Place **C** & **D** on **B** aligning pins in holes.
4. Push **E** (x2) through holes and hand-tighten

